

6 Return

To return your sample, place all labeled tubes and the absorbent sheet into the biohazard bag and seal it.

Insert the completed test requisition form and/or the sample information card into the second pocket in the biohazard bag.

Put the sealed biohazard bag into the GeneDx box and close it.

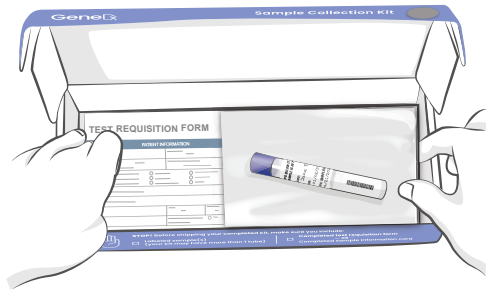

Place the box inside the FedEx Clinical Pak, remove the adhesive strip and seal the FedEx Pak. Attach the FedEx label to the outside of the Pak.

Call FedEx at (800) 463-3339 to schedule a pickup, or drop off at a local FedEx location. You can find the nearest FedEx location to you by calling FedEx or visiting [FedEx.com/locate](https://www.fedex.com/locate).

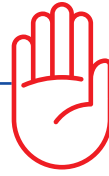

IMPORTANT

Before sealing and shipping the completed kit, make sure to include:



Samples labeled with name, date of birth and date of collection (i.e. tube or both tubes)

Unlabeled samples will not be processed.



Completed test requisition form

—OR—

Completed sample info card

GeneDx

Buccal (Oral Cheek Swab) Sample Collection

Please read these full instructions before collecting the sample.

You can also scan this QR code, using the camera on your mobile phone, to watch a brief video with oral cheek swab collection instructions or visit [GeneDx.com/Buccal](https://www.genedx.com/Buccal).



Take everything out of the GeneDx box and put on a table/counter in front of you.

1 Prep

Do not drink anything, eat anything (including gum, mints, lozenges or hard candies) or smoke for at least 30 minutes before collecting the sample.



GeneDx

207 Perry Parkway, Gaithersburg, MD 20877
T 1 (888) 729-1206 or 1 (301) 519-2100
F 1 (201) 421-2010

support@genedx.com • www.genedx.com

©2022 GeneDx, LLC. All Rights Reserved

2 Swab

Remove one oral swab from its sealed package without touching the sponge tip or removing from the tube.

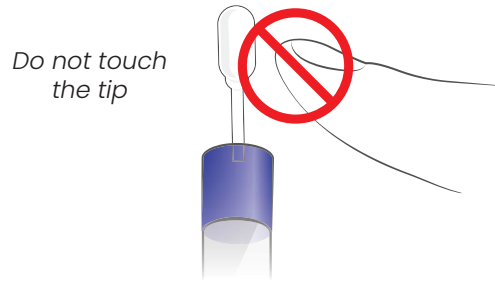

Place the sponge on the upper inside of the left cheek in the space where the upper gums meet the cheek. Sweep (or drag) along this area in a back-and-forth motion at least 10 times. Repeat the sweeping motion in the middle and lower sides of the left cheek. **Remember: Do not rub the teeth.**

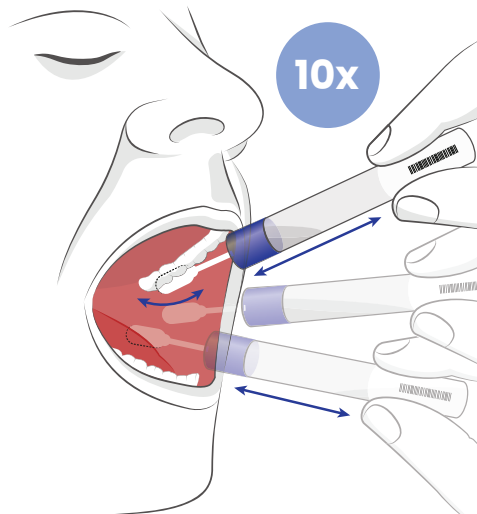

3 Shake

Hold the tube upright to prevent anything from spilling. Unscrew the blue cap and turn the cap upside down and insert the sponge into the tube with the solution. Close the cap tightly. Shake vigorously, up and down 10 times. **Repeat steps 2 and 3 using the second swab on the right cheek.**

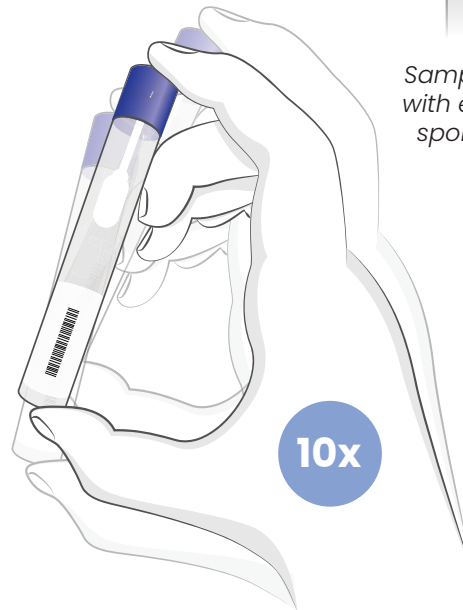

Shake the sealed sample vigorously 10 times

4 Label

Fill out the provided labels with the name and date of birth of the person whose sample is contained in the tubes, as well as the date the sample was collected. Place the labels onto each of the tubes.

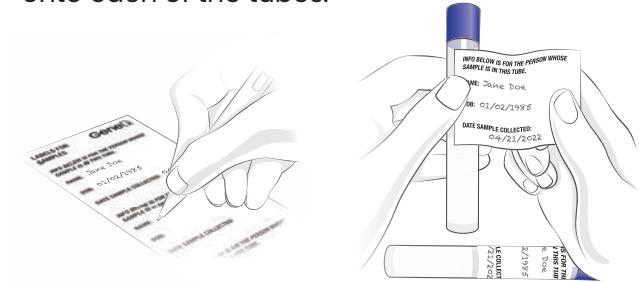

Reminder: All tubes must be labeled. Unlabeled samples will not be processed.

5 Sample Information

Reminder: Every sample MUST be accompanied by a completed test requisition form (preferred) or a completed sample info card. **Samples submitted without this form or card will not be processed.**

